

Form 1 • Original not in this Department.

OFFICE USE ONLY

51/1460

A copy of this plan has been approved Ms. 4424 Gfn. Department of Lands.

PLAN OF

PART OF PORTION 435
PLAN MICROFILMED

NO ADDITIONS OR AMENDMENTS TO BE MADE

Man./Shire/City... Bellinghen

Town or Locality... South Bellinghen

Parish... South Bellinghen

County... Raleigh

Scales 2¹/₂ chains to an inch

Registered:

C.A.:

Title System:

Purpose:

Ref. Map:

Last Plan:

SCALE: 2Ch. to an inch.

Lot 1 app'd. for 2 a 0 r 38 p.
by ded'n (Rds 71.935) (ded'n scale n.)
(Closed road added)
J.S.L.
Authorised Officer. *[Signature]*
31.7.67

REFERENCE MARKS			
Cor	Bearing	Distance	From
a	110° 10' 30"	2.31	4.1. Pipe
b	215° 30'	2.52	4.1. Pipe

Note: Steeply falling land, medium timber.

Surround Areas:

Lot 1: +23920 ac.

Lot 2: 27.59196 ac.

① B.I. Shelter & Picnic table 10'x8' & 100 Gall. water tank, erected 1963.

② This area has been bulldozed, leveled & partly grassed.

SCALE: 5 Ch. to an inch.

Areas altered in
Land Board Office.

Signatures, Seals and Statements of Dedications and Easements.

Lot 1: Measured for Reserve for Public Recreation.

do R86523 from Sale or Lease generally (25A) Notified 10.11.67 Rev'd 10.11.67

" R86523 from Sale or Lease generally (25A) Not 28.3.69 Rev'd 28.3.69

Checked & Charted *[Signature]* 25.7.67

Examined *[Signature]* 31.7.1967

Plan Approved *[Signature]* 31.7.67

Lot 1: R87120 for Public Recreation. Not'd 28th March '69
for Road closed gatz 17.9.71 Rds 71.935. (Added 19.11.71 to R87120.)

4424-3050

Ms. 4424 Gfn.

LB. 65-206. Pks. 65-239

1. Richard Owen Rushton

of Coffs Harbour

a surveyor registered under the Surveyors Act, 1929, as amended, hereby certify that the survey represented in this plan is accurate and has been made (1) by me (2) under my immediate supervision in accordance with the Survey Practice Regulations, 1933 and was completed on 15th March 1963

Signature *[Signature]*

Surveyor registered under Surveyors Act, 1929 as amended.
Datum Line of Azimuth X-Y

Approved by Council. I hereby certify that the requirements of the Local Government Act, 1919 (other than the requirements for registration of plans), have been complied with by the applicant in relation to the proposed subdivision and/or new roads set out herein.

Subdivision No. 8/66 Date 22/9/66

Council Clerk *[Signature]*

(7943)

Sydney, 17th June, 1977.

REVOCATION OF DEDICATION AND GRANT

WHEREAS under section 25 of the Crown Lands Consolidation Act, 1913, power is given for the revocation of any dedication of Crown land dedicated by the Crown: Now, therefore, I do hereby declare that all preliminary action has been taken in connection with the revocation of the dedication and grant of the area described hereunder, and I do hereby revoke the said dedication and grant, in so far as they apply to or affect the area described hereunder.

W. F. CRABTREE, Minister for Lands.

Land District and Shire—Bellingen

Parish Leigh, County Fitzroy, 1 012 square metres, being portion 156, dedicated 30th July, 1913, for Public Hall at Leigh, and comprising the whole of the land in Crown Grant, volume 2512, folio 241. Ten. 76-2809.

(7945)

Sydney, 17th June, 1977.

WITHDRAWAL FROM SPECIAL LEASE

IN pursuance of section 233 (1), Crown Lands Consolidation Act, 1913, the Crown lands hereunder described are withdrawn for the purpose of "Public Recreation" from the special lease mentioned.

W. F. CRABTREE, Minister for Lands.

Land District—Taree; Shire—Great Lakes

Parish Forster, County Gloucester, 1.424 hectares, being portion 425, and being Special Lease 64-30, Taree, held by the New South Wales Planning and Environment Commission. Pks 76-1089.

(7952)

Sydney, 17th June, 1977.

NOTIFICATION OF VESTING OF LANDS IN PURSUANCE OF THE PROVISIONS OF SECTION 37AAA OF THE CROWN LANDS CONSOLIDATION ACT, 1913

IN pursuance of the subject provisions, I, WILLIAM FREDERICK CRABTREE, Minister for Lands, being of the opinion that—

- (a) the lands described in the First to the Seventh Schedules and in each Part of the Eighth to the Fourteenth Schedules hereto are respectively a public reserve or are suitable for use as a public reserve within the meaning of the Local Government Act, 1919; and
- (b) it is proper that, having regard to the purpose (if any) for which the lands described in the First to the Seventh Schedules and in each Part of the Eighth to the Fourteenth Schedules are used, those lands should be respectively vested in the council specified in each Schedule,

do, by this notification, respectively vest the lands described in each of those Schedules in the council specified therein for an estate in fee simple subject to the following reservations and exceptions unto Her Majesty Elizabeth the Second, by the Grace of God Queen of Australia and Her Other Realms and Territories, Head of the Commonwealth, Her Heirs and Successors of—

- (i) all minerals which those lands contain with full power and authority for Her Majesty, Her Heirs and Successors and such person or persons, as shall from time to time be authorized by Her Majesty, Her Heirs or Successors to enter upon those lands and to search for mine dig and remove those minerals;
- (ii) all such parts and so much of those lands as may hereafter be required for public ways in over and through the same to be set out by His Excellency the Governor for the time being of the State of New South Wales or some person by him authorized in that respect with full power for Her Majesty, Her Heirs and Successors and for His Excellency the Governor as aforesaid by such person or persons as shall be by Her Majesty, Her Heirs or Successors or His Excellency the Governor as aforesaid authorized in that behalf to make and conduct all such public ways; and
- (iii) the right of full and free ingress, egress and regress into out of and upon those lands for the several purposes aforesaid or any of them.

The lands described in the First to the Seventh Schedules and in each Part of the Eighth to the Fourteenth Schedules hereto are respectively declared to be a public reserve for the purposes of the Local Government Act, 1919.

This notification shall take effect on and from the date of publication of this Gazette.

Signed at Sydney, this sixth day of June, 1977.

W. F. CRABTREE, Minister for Lands.

V.S. No. 48; Pks 77-81

FIRST SCHEDULE*Land District and Shire—Bellingen*

Parish South Bellingen, County Raleigh, 9 055 square metres at Bellingen, Reserve 87120 for Public Recreation, notified 28th March, 1969, being lot 1 on plan catalogued Ms 4424 Gfn R, in the Department of Lands.

The lands in this Schedule are vested in The Council of the Shire of Bellingen.

SECOND SCHEDULE*Land District—Bellingen; Shire—Nambucca*

Parish Nambucca, County Raleigh, about 5.056 hectares in the Town of Nambucca Heads, Reserve 63695 for Public Recreation, notified 23rd December, 1932, being the land shown by hatched edging on diagram hereunder. Plan 3690-1714.

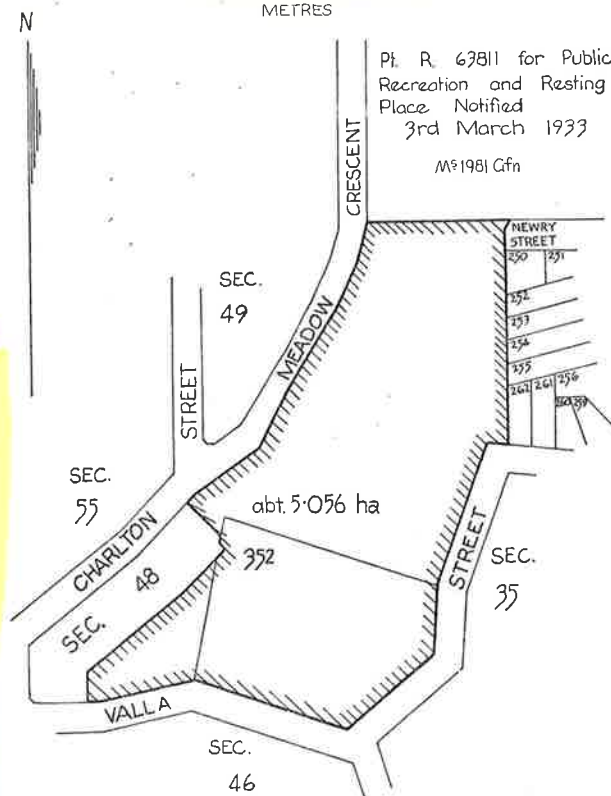

The lands in this Schedule are vested in The Council of the Shire of Nambucca.

THIRD SCHEDULE*Land District—Casino; Shire—Richmond River*

Parish Nandabah, County Richmond, about 6.116 hectares in the Village of Rappville, Reserve 75563 for Public Recreation, notified 30th January, 1953, being the land bounded by Coombell Street, Green Street, Pearse Street and a line being the northerly prolongation of the eastern boundary of allotment 10 of section 5. The area of this land is limited to the surface and to a depth of 20 metres below the surface.

The lands in this Schedule are vested in The Council of the Shire of Richmond River.

FOURTH SCHEDULE*Land District and City—Grafton*

Parish Great Marlow, County Clarence, 8 878 square metres at Grafton, Reserve 75420 for Public Recreation, notified 7th November, 1952, being the land bounded by allotments 17, 9, 10 and 12 of section 95, Powell Street and Turf Street. The area of this land is limited to the surface and to a depth of 20 metres below the surface.

The lands in this Schedule are vested in The Council of the City of Grafton.

FIFTH SCHEDULE*Land District—Murwillumbah; Shire—Tweed*

Parish Terranora, County Rous, about 3.9 hectares at Tweed Heads, Reserve 58447 for Public Recreation, notified 4th December, 1925, being the land bounded by Adelaide Street, Florence Street, Recreation Street and the land appropriated for Housing Purposes, Gazette, 18th July, 1947. The area of this land is limited to the surface and to a depth of 20 metres below the surface. Plan Ms 1832 Gfn R.

The lands in this Schedule are vested in The Council of the Shire of Tweed.